

# MIW-POWER-PRO-PFP INSTALLATION INSTRUCTIONS

## CAUTION:

Only for use with 15 Amp circuits utilizing a minimum of 14 AWG. Make sure the circuit is not live before installation. If you are unsure how to perform this task, please contact an electrician.

## STEP 1:

Select a location close to the equipment. In the case of a flat panel display, the recommended location is one that is behind the device and hidden from view once the Plasma TV is mounted. Cut a 4" wide by 3 3/4" high hole in the wall for the outlet box.

## STEP 2:

Run the building wire (e.g. Romex) through a rear opening in the outlet box (not included). No more than 1" of wire sheath should extend into the outlet box. 3" of wire should be able to extend beyond the opening of the outlet box. Install the outlet box in the hole.

## STEP 3:

Strip building wire. Using the included wire nuts, first connect the ground wires - green insulated on the MIW-Power and bare copper on the building wire. Then connect the neutral wires (white), then the hot wires (black).

## STEP 4:

Neatly fold the AC wires as you install the Max In-Wall in the outlet box and secure with the included screws.

## STEP 5:

Turn the power on to the circuit. The blue Power indicator should light up, indicating the outlet is ready for use.

## NOTES:

In the event of a hazardous voltage situation, the red Unsafe Voltage indicator will blink until the voltage returns to a safe level.

## Signal Protection Module Usage:

PF Power In-Wall signal protection modules (sold separately), while not necessary for surge protection in the Max In-Wall Power-Pro, may be used to provide a clean looking interface for the signal lines. When used in the proper manner the modules also provide total protection to the connected equipment.

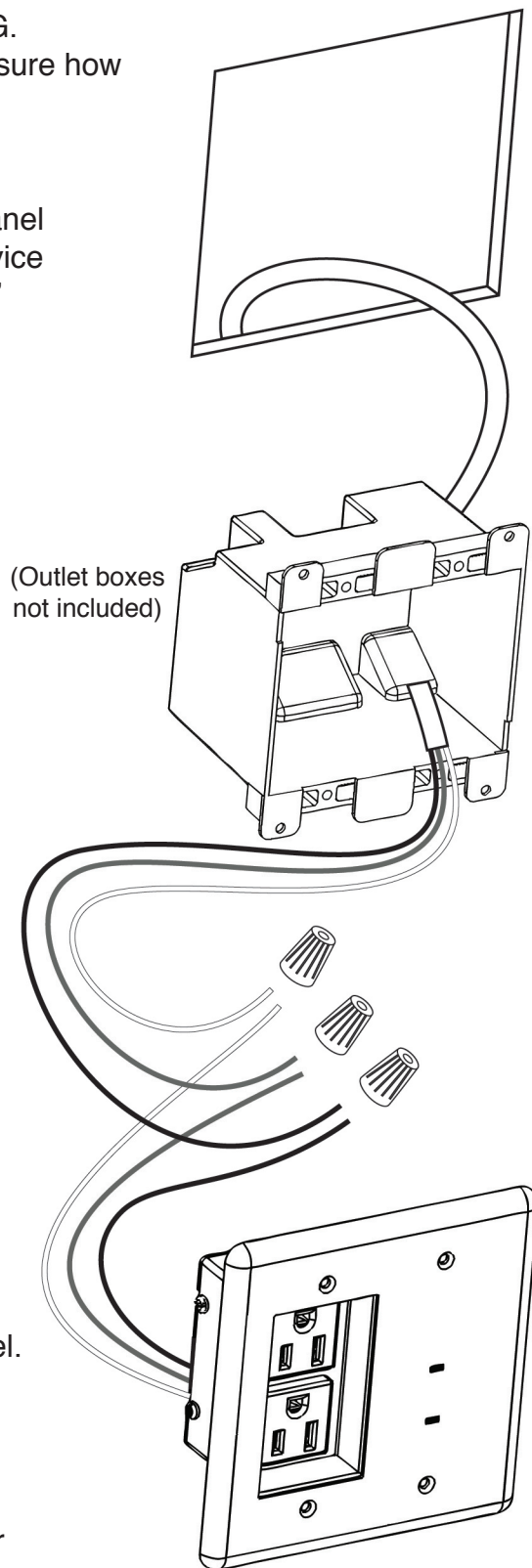

## MIW-POWER-PRO-PFP SPECIFICATIONS

### AC Circuit

AC Outlets, Total: .....2  
Line Voltage: .....120V, 50/60Hz  
Total Current Capacity: .....15A  
UL 1449 Suppression Rating: .....330 V  
Protection Modes: .....L-N, L-G, N-G  
Energy Dissipation: .....546 Joules  
Peak Impulse Current: .....32,500A  
Catastrophic Surge Circuit: .....Yes  
Thermal Fusing: .....Yes

### AVM (Automatic Voltage Monitoring) Circuit

Over-voltage shutoff: .....142VAC  $\pm$  5VAC  
Under-voltage shutoff: .....84VAC  $\pm$  6VAC

### Power Outlet Faceplate

AC Connectors: .....2 NEMA 5-15  
Noise Filtration: .....Level 1  
Signal Line Protection: Not Included / Modules  
Sold  
Separately

Specifications are subject to changes due to product upgrades and improvements.

## CONTENTS

One MAX In-Wall  
power outlet  
enclosure

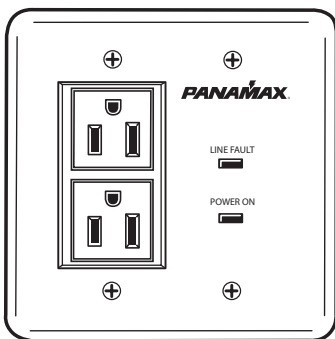

Included Installation Accessories:

- (3) Wire Nuts
- (4) Mounting Screws

## CONTACTING PF POWER

PF Power  
1690 Corporate Circle  
Petaluma, CA 94954  
Phone - 707-283-5900 or 800-472-5555  
Fax - 707-283-5901  
Web - [www.panamax.com](http://www.panamax.com)

Customer Relations  
7:30 AM – 4:30 PM, M-F Pacific Time  
Email - [custrelations@panamax.com](mailto:custrelations@panamax.com)